

eritage Window and Door, Inc.

6141 Casmere, Detroit, MI 48212
Phone (313) 893-2000, FAX (313) 893-2007

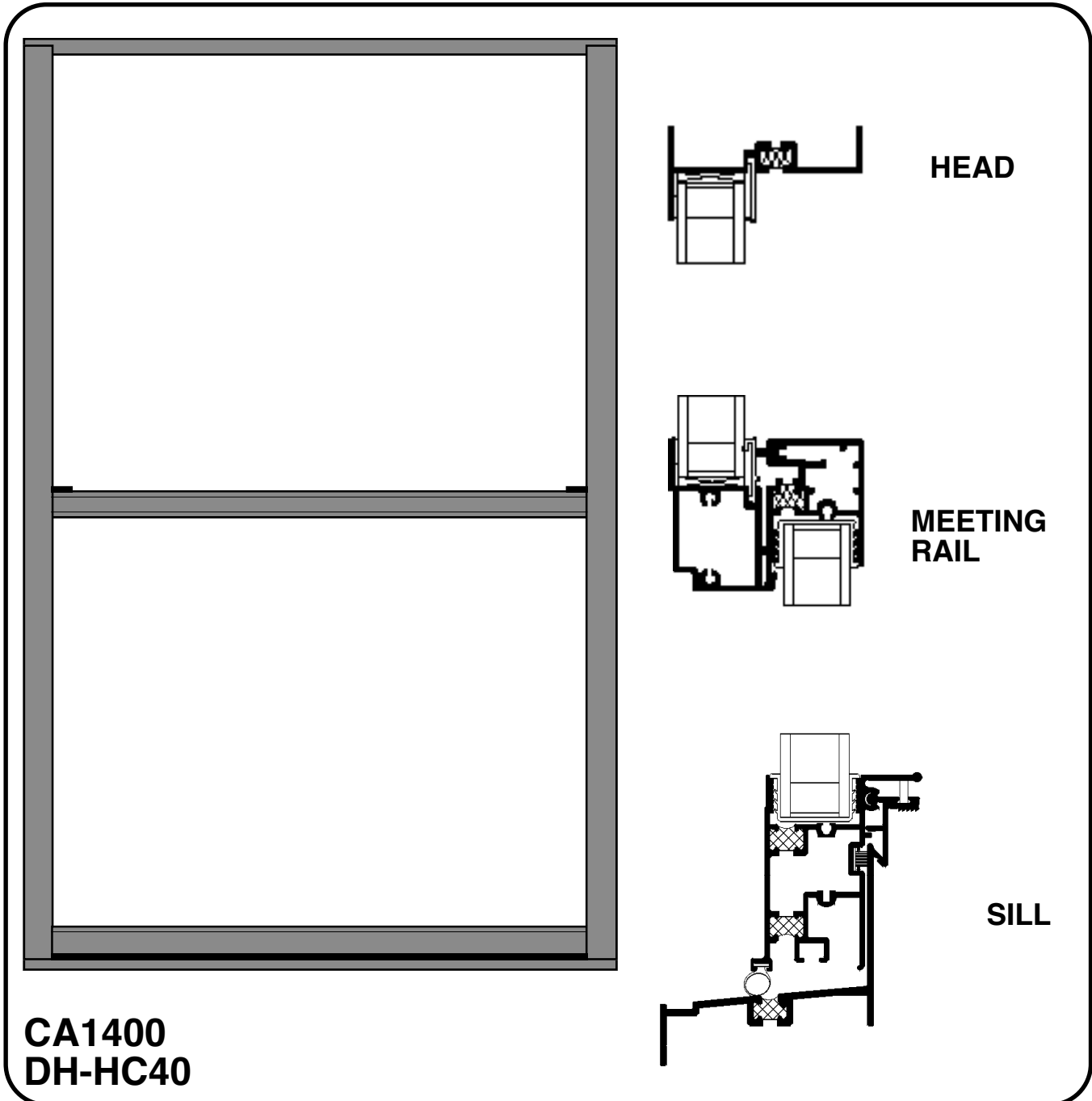

**CA1400
DH-HC40**

Thermally Broken, High Performance, Heavy Commercial, Single Hung Tilt Window
PRESERVING AMERICA'S WINDOW HERITAGE

MODEL CA1400 SPECIFICATIONS

Description

Thermally broken, High-Performance Single Hung Tilt window.

Application

This custom built, economical, high performance, thermally broken single hung is specifically designed for Hotels, Apartments, Historic replacement, Schools, Homes, and High-rise buildings.

Special Features

This product is a slimmed down version of our 3.25" HC-40 Double Hung with full 7/8" glass and full size hardware, not a retested residential single hung. This provides maximum performance for the price. True Muntin available for 3 light configuration. Applied Muntin available (with 5/8" glass) Note special sill design and slimmed down meeting rail to properly replicate old wood double hung windows.

Construction

2.562" frame depth Nominal wall thickness .062" (sill .078") 6063 T-5 extruded aluminum with integral poured-in-place thermal barrier. Joinery shall be butted and coped with stainless steel screws into integral screw ports.

Glazing

Standard: Factory Glazed with 7/8" sealed glass
Optional: Factory glazed with 7/8" insulated panel.

Finishes

Standard: Bronze, White or Wicker powdercoat.
Optional: Bronze or Clear anodized. Custom enamel or Duranar® finishes available, special order only

Hardware

Nylon or Zinc Diecast tilt latches, automatic sill locks, Spiral Balances standard, Caldwell Ultralift® balances available.

Accessories

A full line of standard and historic pans and trims available, receptors and mulls available.

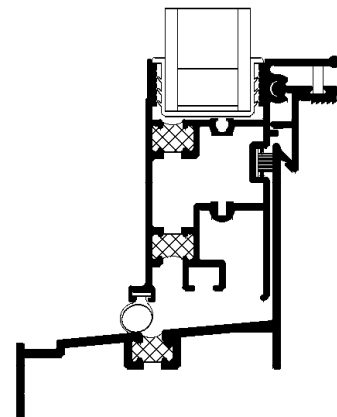
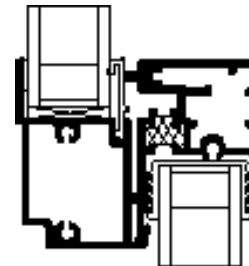
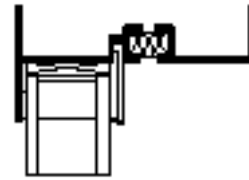

**For more information, contact your Heritage Window and Door, Inc.
sales representative**

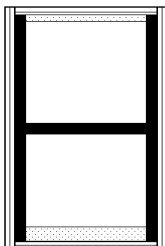

Heritage Window and Door, Inc.
6141 Casmere, Detroit, MI 48212
(313) 893-2000; FAX (313) 893-2007