

eritage Window and Door, Inc.

6141 Casmere, Detroit, MI 48212
Phone (313) 893-2000, FAX (313) 893-2007

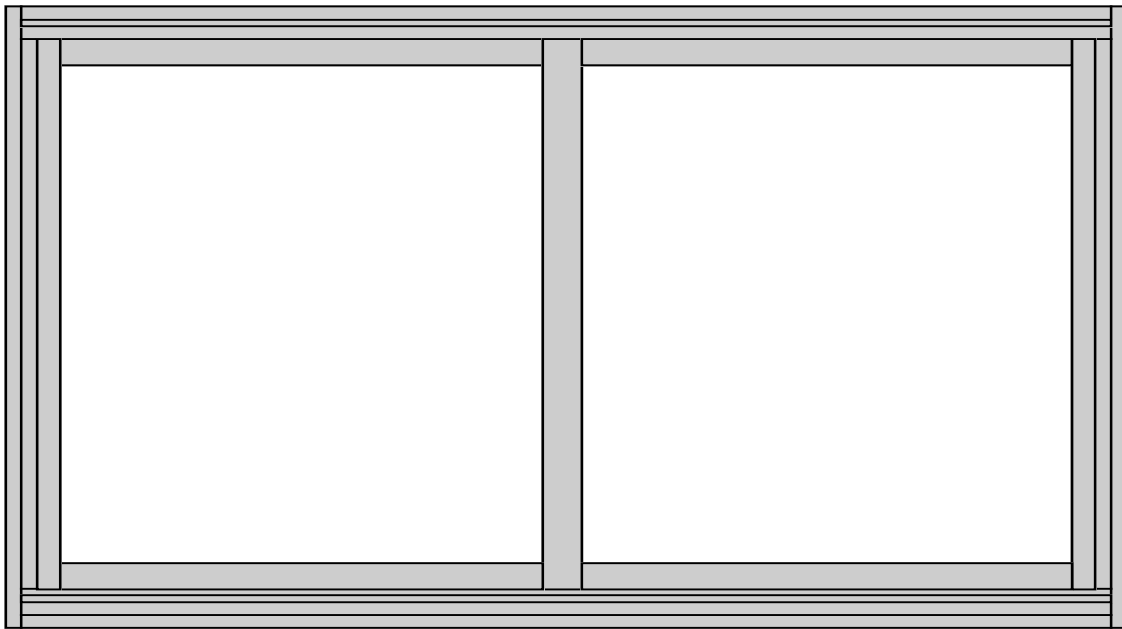

HEAD

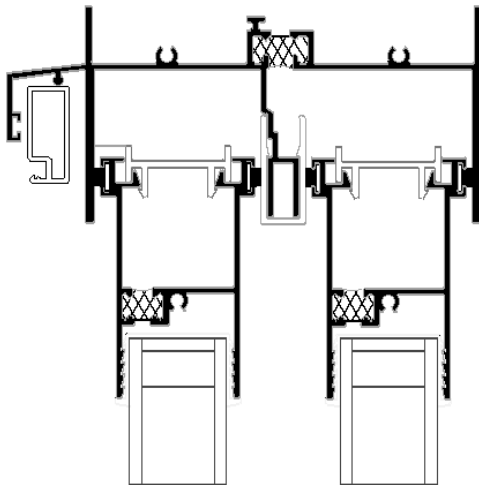

SILL

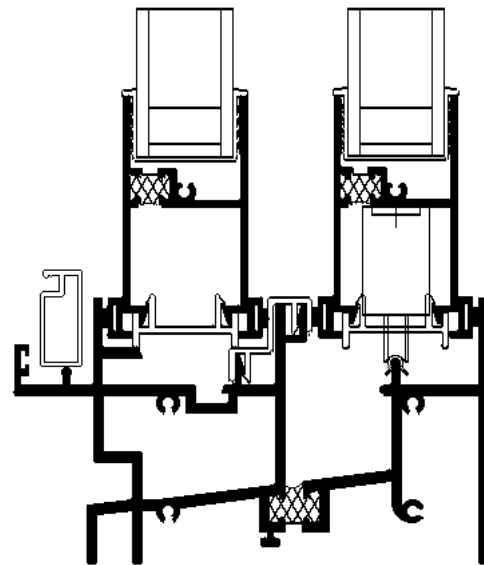

CA1650
HS-HC40/60

Thermally Broken, Monumental, Horizontal Sliding Window
PRESERVING AMERICA'S WINDOW HERITAGE

MODEL CA1650 SPECIFICATIONS

Description

Thermally broken, monumental, double sash horizontal sliding window.

Application

This thermally broken slider is designed for high performance, heavy use and oversize applications, specifically schools, hospitals and high-rise buildings.

Special Features

Double sash construction allows for fixed panel removal for ease of installation and service. Ultra-heavy duty hardware and stainless steel track cover provide reduced operating force and greater longevity

Construction

Nominal wall thickness .062" (.093" sill)6063 T-5 extruded aluminum with integral poured-in-place thermal barrier. Joinery shall be butted and coped with stainless steel screws into integral screw ports, Sash shall be telescoped for additional strength.

Glazing

Standard: Factory glazed with 1" glass

Optional: Factory glazed with 1" insulated panel.

Finishes

Standard: Bronze acrylic enamel, clear or bronze anodized.

Optional: Custom enamel or Kynar® finishes available, special order only

Hardware

Screw adjustable double wheel ball-bearing rollers, Stainless steel track cover, heavy duty pull handle and lock, automatic spring loaded dust-plugs.

Accessories

A full line of standard and historic panes and trims available, receptors and mulls available.

**For more information, contact your Heritage Window and Door, Inc.
sales representative**

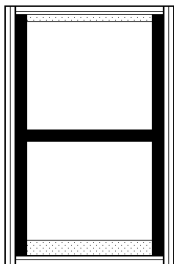

Heritage Window and Door, Inc.
6141 Casmere, Detroit, MI 48212
Ph (313) 893-2000; FAX (313) 893-2007